

# FLEA MINI RECESSED

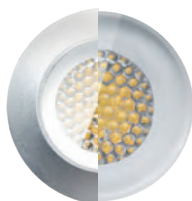

### PERFORMANCE DATA

TRUE POWER (W)  
TRUE LUMENS (3000K)  
TRUE LUMENS (4000K)  
L90 LIFETIME (HRS)

2.0  
150 (.01)  
156 (.01)  
90.000 - T<sub>a</sub> 35°C

### BUILD DATA

CLASS  
NOMINAL VOLTAGE  
POWER SUPPLY  
EXTERNAL CABLE

III  
24V DC - DIMMABLE  
SEE END OF SECTION  
SINGLE INPUT  
2-POLES NEOPRENE  
IP67 - IK10  
1500KG (WALK OVER)

PROTECTION RATING  
MAX LOAD

2.0  
150 (.01)  
156 (.01)  
90.000 - T<sub>a</sub> 35°C

III  
24V DC - DIMMABLE  
SEE END OF SECTION  
SINGLE INPUT  
2-POLES NEOPRENE  
IP67 - IK10  
1500KG (WALK OVER)

### DIMENSIONS

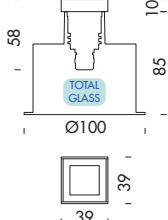
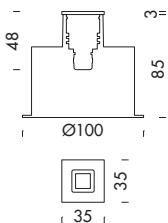
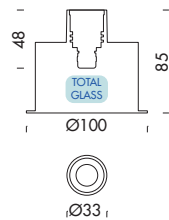
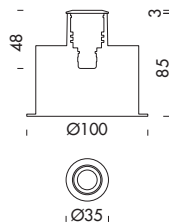

### CODE COMPOSITION



#### ● FINISH

.3 - ANODIZED MATTE BLACK  
.5 - ANODIZED ALUMINUM  
.6 - AISI 316L S.STEEL  
.9 - TOTAL GLASS

#### ■ LED COLOR

.2 - 2700°K - CRI > 80  
.3 - 3000°K - CRI > 80  
.4 - 4000°K - CRI > 80

#### ▲ BEAM

.01 - 10° SPOT  
.02 - 30° MEDIUM  
.04 - 14° X 20° ELLIPTICAL  
.05 - DIFFUSED



.3 - ANODIZED MATTE BLACK  
.5 - ANODIZED ALUMINUM  
.6 - AISI 316L S.STEEL  
.9 - TOTAL GLASS

.2 - 2700°K - CRI > 80  
.3 - 3000°K - CRI > 80  
.4 - 4000°K - CRI > 80

.01 - 10° SPOT  
.02 - 30° MEDIUM  
.04 - 14° X 20° ELLIPTICAL  
.05 - DIFFUSED

### ACCESSORIES

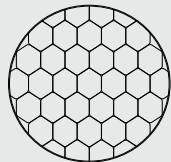

HONEYCOMB SCREEN  
(TO BE ORDERED TOGETHER  
WITH THE PRODUCT)

A1006

# FLEA MINI RECESSED

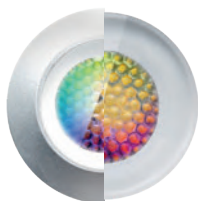

### PERFORMANCE DATA

TRUE POWER (W)  
TRUE LUMENS (3000K)  
TRUE LUMENS (4000K)  
L90 LIFETIME (HRS)

5 (ALL COLORS)  
R=25, G=52,  
B=13, W=84 (6500K)  
90.000 - Ta 35°C

5 (ALL COLORS)  
R=25, G=52,  
B=13, W=84 (6500K)  
90.000 - Ta 35°C

### BUILD DATA

CLASS  
NOMINAL VOLTAGE  
POWER SUPPLY  
EXTERNAL CABLE

III  
350mA  
SEE END OF SECTION  
SINGLE INPUT  
8-POLES NEOPRENE  
IP67 - IK10  
1500KG (WALK OVER)

III  
350mA  
SEE END OF SECTION  
SINGLE INPUT  
8-POLES NEOPRENE  
IP67 - IK10  
1500KG (WALK OVER)

### DIMENSIONS

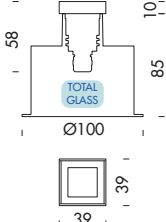
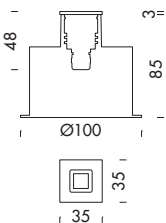
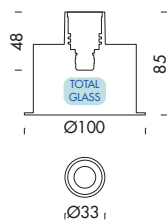
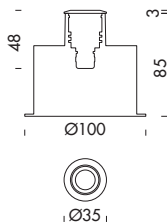

### CODE COMPOSITION

10112  
● ■ ▲  
.3 - ANODIZED MATTE BLACK  
.5 - ANODIZED ALUMINUM  
.6 - AISI 316L S.STEEL  
.9 - TOTAL GLASS

● FINISH

■ LED COLOR

▲ BEAM

.5 - RGB+W

.02 - 30° MEDIUM  
.05 - DIFFUSED

10113  
● ■ ▲  
.3 - ANODIZED MATTE BLACK  
.5 - ANODIZED ALUMINUM  
.6 - AISI 316L S.STEEL  
.9 - TOTAL GLASS

.5 - RGB+W

.02 - 30° MEDIUM  
.05 - DIFFUSED

### ACCESSORIES

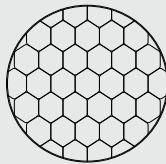

HONEYCOMB SCREEN  
(TO BE ORDERED TOGETHER  
WITH THE PRODUCT)

A1006

# FLEA MINI DOWNLIGHT

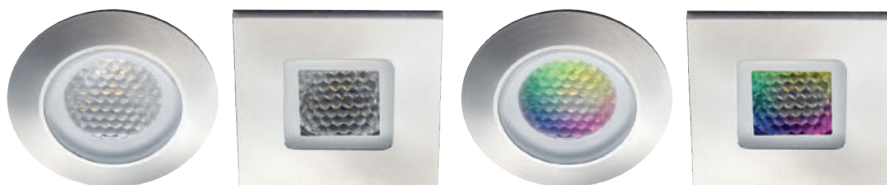

## PERFORMANCE DATA

TRUE POWER (W)	2.0	2.0	5 (ALL COLORS)	5 (ALL COLORS)
TRUE LUMENS (3000K)	150 (.01)	150 (.01)	R=25, G=52,	R=25, G=52,
TRUE LUMENS (4000K)	156 (.01)	156 (.01)	B=13, W=84 (6500K)	B=13, W=84 (6500K)
L90 LIFETIME (HRS)	90.000 - Ta 35°C	90.000 - Ta 35°C	90.000 - Ta 35°C	90.000 - Ta 35°C

## BUILD DATA

CLASS	III	III	III	III
NOMINAL VOLTAGE	24V DC - DIMMABLE	24V DC - DIMMABLE	350mA	350mA
POWER SUPPLY	SEE END OF SECTION	SEE END OF SECTION	SEE END OF SECTION	SEE END OF SECTION
EXTERNAL CABLE	SINGLE INPUT	SINGLE INPUT	SINGLE INPUT	SINGLE INPUT
PROTECTION RATING	2-POLES NEOPRENE IP67 - IK10	2-POLES NEOPRENE IP67 - IK10	8-POLES NEOPRENE IP67 - IK10	8-POLES NEOPRENE IP67 - IK10

## DIMENSIONS

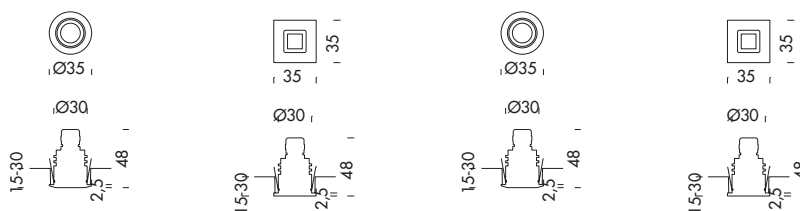

## CODE COMPOSITION

	20110	20111	20112	20113
● FINISH	.3 - ANODIZED MATTE BLACK .5 - ANODIZED ALUMINUM .6 - AISI 316L S.STEEL	.3 - ANODIZED MATTE BLACK .5 - ANODIZED ALUMINUM .6 - AISI 316L S.STEEL	.3 - ANODIZED MATTE BLACK .5 - ANODIZED ALUMINUM .6 - AISI 316L S.STEEL	.3 - ANODIZED MATTE BLACK .5 - ANODIZED ALUMINUM .6 - AISI 316L S.STEEL
■ LED COLOR	.2 - 2700°K - CRI > 80 .3 - 3000°K - CRI > 80 .4 - 4000°K - CRI > 80	.2 - 2700°K - CRI > 80 .3 - 3000°K - CRI > 80 .4 - 4000°K - CRI > 80	.5 - RGB+W	.5 - RGB+W
▲ BEAM	.01 - 10° SPOT .02 - 30° MEDIUM .04 - 14° X 20° ELLIPTICAL .05 - DIFFUSED	.01 - 10° SPOT .02 - 30° MEDIUM .04 - 14° X 20° ELLIPTICAL .05 - DIFFUSED	.02 - 30° MEDIUM .05 - DIFFUSED	.02 - 30° MEDIUM .05 - DIFFUSED

## ACCESSORIES

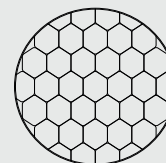

HONEYCOMB SCREEN  
(TO BE ORDERED TOGETHER  
WITH THE PRODUCT)

A1006

# FLEA MINI UNDERWATER



## PERFORMANCE DATA

TRUE POWER (W)	2.0	5 (ALL COLORS)	2.0	5 (ALL COLORS)
TRUE LUMENS (3000K)	150 (.01)	R=25, G=52,	150 (.01)	R=25, G=52,
TRUE LUMENS (4000K)	156 (.01)	B=13, W=84 (6500K)	156 (.01)	B=13, W=84 (6500K)
L90 LIFETIME (HRS)	90.000 - Ta 35°C	90.000 - Ta 35°C	90.000 - Ta 35°C	90.000 - Ta 35°C

## BUILD DATA

CLASS	III	III	III	III
NOMINAL VOLTAGE	24V DC - DIMMABLE	350mA	24V DC - DIMMABLE	350mA
POWER SUPPLY	SEE END OF SECTION	SEE END OF SECTION	SEE END OF SECTION	SEE END OF SECTION
EXTERNAL CABLE	SINGLE INPUT	SINGLE INPUT	SINGLE INPUT	SINGLE INPUT
PROTECTION RATING	2-POLES NEOPRENE 5MTS IP68 3MTS	8-POLES FEP+RUBBER (5MTS) IP68 3MTS	2-POLES NEOPRENE 5MTS IP68 3MTS	8-POLES FEP + RUBBER 5MTS IP68 3MTS

## DIMENSIONS

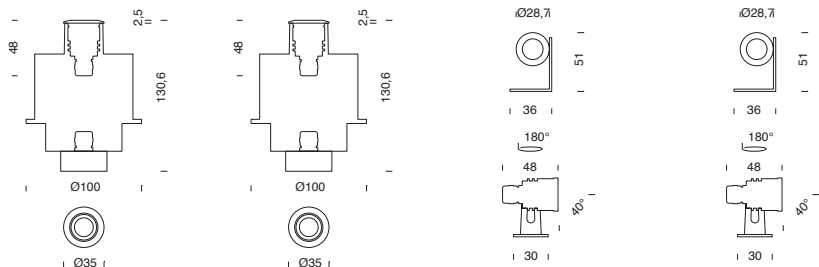

## CODE COMPOSITION

	50103	50104	50132	50133
● FINISH	.6 - AISI 316L S.STEEL	.6 - AISI 316L S.STEEL	.6 - AISI 316L S.STEEL	.6 - AISI 316L S.STEEL
■ LED COLOR	.2 - 2700°K - CRI > 80 .3 - 3000°K - CRI > 80 .4 - 4000°K - CRI > 80	.5 - RGB+W	.2 - 2700°K - CRI > 80 .3 - 3000°K - CRI > 80 .4 - 4000°K - CRI > 80	.5 - RGB+W
▲ BEAM	.01 - 10° SPOT .02 - 30° MEDIUM .04 - 14° X 20° ELLIPTICAL .05 - DIFFUSED	.02 - 30° MEDIUM .05 - DIFFUSED	.01 - 10° SPOT .02 - 30° MEDIUM .04 - 14° X 20° ELLIPTICAL .05 - DIFFUSED	.02 - 30° MEDIUM .05 - DIFFUSED

# FLEA RECESSED



## PERFORMANCE DATA

TRUE POWER (W)  
411 (.01)  
TRUE LUMENS (3000K)  
428 (.01)  
TRUE LUMENS (4000K)  
90.000 - T<sub>a</sub> 35°C

## BUILD DATA

CLASS  
24V DC - DIMMABLE  
SEE END OF SECTION  
SINGLE INPUT  
2-POLES NEOPRENE  
IP67 - IK10  
1500KG (WALK OVER)

## DIMENSIONS

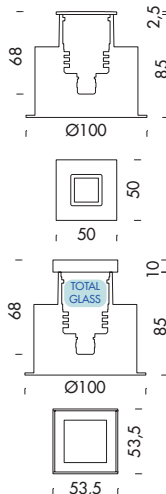
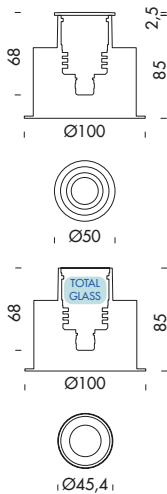

## CODE COMPOSITION

### ● FINISH

.3 - ANODIZED MATTE BLACK  
.5 - ANODIZED ALUMINUM  
.6 - AISI 316L S.STEEL  
.9 - TOTAL GLASS

### ■ LED COLOR

.2 - 2700°K - CRI > 80  
.3 - 3000°K - CRI > 80  
.4 - 4000°K - CRI > 80

### ▲ BEAM

.01 - 10° SPOT  
.02 - 30° MEDIUM  
.04 - 14° X 20° ELLIPTICAL  
.05 - DIFFUSED

## 10133

.3 - ANODIZED MATTE BLACK  
.5 - ANODIZED ALUMINUM  
.6 - AISI 316L S.STEEL  
.9 - TOTAL GLASS

.2 - 2700°K - CRI > 80  
.3 - 3000°K - CRI > 80  
.4 - 4000°K - CRI > 80

.01 - 10° SPOT  
.02 - 30° MEDIUM  
.04 - 14° X 20° ELLIPTICAL  
.05 - DIFFUSED

## ACCESSORIES

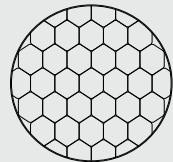

HONEYCOMB SCREEN  
(TO BE ORDERED TOGETHER  
WITH THE PRODUCT)

A1007

# FLEA RECESSED

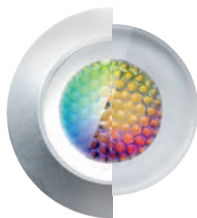

## PERFORMANCE DATA

TRUE POWER (W)  
TRUE LUMENS (3000K)  
TRUE LUMENS (4000K)  
L90 LIFETIME (HRS)

8 (ALL COLORS)  
R=28, G=70,  
B=17, W=96 (6500K)  
90.000 - T<sub>a</sub> 35°C

## BUILD DATA

CLASS  
NOMINAL VOLTAGE  
POWER SUPPLY  
EXTERNAL CABLE

III  
500mA  
SEE END OF SECTION  
SINGLE INPUT  
8-POLES NEOPRENE  
IP67 - IK10  
1500KG (WALK OVER)

PROTECTION RATING  
MAX LOAD

8 (ALL COLORS)  
R=28, G=70,  
B=17, W=96 (6500K)  
90.000 - T<sub>a</sub> 35°C

III  
500mA  
SEE END OF SECTION  
SINGLE INPUT  
8-POLES NEOPRENE  
IP67 - IK10  
1500KG (WALK OVER)

## DIMENSIONS

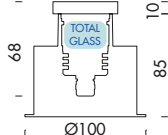
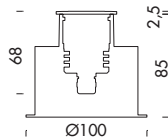
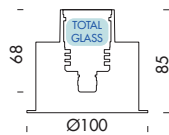
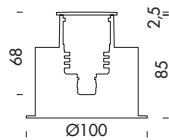

## CODE COMPOSITION



● FINISH

.3 - ANODIZED MATTE BLACK  
.5 - ANODIZED ALUMINUM  
.6 - AISI 316L S.STEEL  
.9 - TOTAL GLASS

■ LED COLOR

.5 - RGB+W

▲ BEAM

.02 - 30° MEDIUM  
.05 - DIFFUSED



.3 - ANODIZED MATTE BLACK  
.5 - ANODIZED ALUMINUM  
.6 - AISI 316L S.STEEL  
.9 - TOTAL GLASS

.5 - RGB+W

.02 - 30° MEDIUM  
.05 - DIFFUSED

## ACCESSORIES

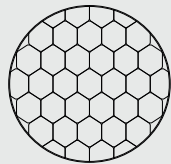

HONEYCOMB SCREEN  
(TO BE ORDERED TOGETHER  
WITH THE PRODUCT)

A1007

# FLEA C



1 x 180°



2 x 120°

### PERFORMANCE DATA

TRUE POWER (W)	4.0
TRUE LUMENS (3000K)	67 (.05)
TRUE LUMENS (4000K)	70 (.05)
L90 LIFETIME (HRS)	90.000 - Ta 35°C

4.0
80 (.05)
83 (.05)
90.000 - Ta 35°C

### BUILD DATA

CLASS	III
NOMINAL VOLTAGE	24V DC - DIMMABLE
POWER SUPPLY	SEE END OF SECTION
EXTERNAL CABLE	SINGLE INPUT
	2-POLES NEOPRENE
BEAM	1 x 180°
PROTECTION RATING	IP67 - IK10
MAXIMUM LOAD	1500KG (WALK OVER)

III
24V DC - DIMMABLE
SEE END OF SECTION
SINGLE INPUT
2-POLES NEOPRENE
2 x 120°
IP67 - IK10
1500KG (WALK OVER)

### DIMENSIONS

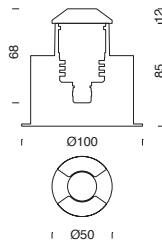
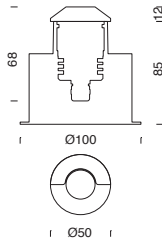

### CODE COMPOSITION

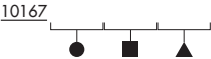

● FINISH	.3 - ANODIZED MATTE BLACK .5 - ANODIZED ALUMINUM .6 - AISI 316L S.STEEL
■ LED COLOR	.2 - 2700°K - CRI > 80 .3 - 3000°K - CRI > 80 .4 - 4000°K - CRI > 80
▲ BEAM	.05 - DIFFUSED

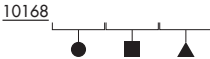

.3 - ANODIZED MATTE BLACK .5 - ANODIZED ALUMINUM .6 - AISI 316L S.STEEL
.2 - 2700°K - CRI > 80 .3 - 3000°K - CRI > 80 .4 - 4000°K - CRI > 80
.05 - DIFFUSED

# FLEA DOWNLIGHT

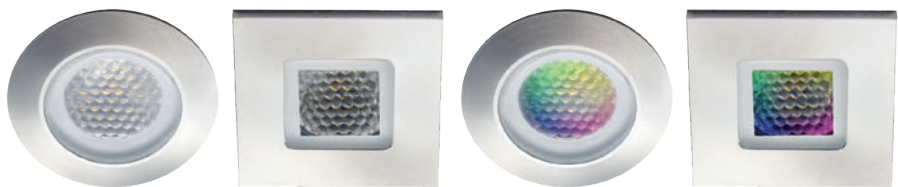

## PERFORMANCE DATA

TRUE POWER (W)  
TRUE LUMENS (3000K)  
TRUE LUMENS (4000K)  
L90 LIFETIME (HRS)

4.0  
411 (.01)  
428 (.01)  
90.000 - Ta 35°C

4.0  
411 (.01)  
428 (.01)  
90.000 - Ta 35°C

8 (ALL COLORS)  
R=28, G=70,  
B=17, W=96 (6500K)  
90.000 - Ta 35°C

8 (ALL COLORS)  
R=28, G=70,  
B=17, W=96 (6500K)  
90.000 - Ta 35°C

## BUILD DATA

CLASS  
NOMINAL VOLTAGE  
POWER SUPPLY  
EXTERNAL CABLE

III  
24V DC - DIMMABLE  
SEE END OF SECTION  
SINGLE INPUT  
2-POLES NEOPRENE  
IP67 - IK10

III  
24V DC - DIMMABLE  
SEE END OF SECTION  
SINGLE INPUT  
2-POLES NEOPRENE  
IP67 - IK10

III  
500mA  
SEE END OF SECTION  
SINGLE INPUT  
8-POLES NEOPRENE  
IP67 - IK10

III  
500mA  
SEE END OF SECTION  
SINGLE INPUT  
8-POLES NEOPRENE  
IP67 - IK10

## DIMENSIONS

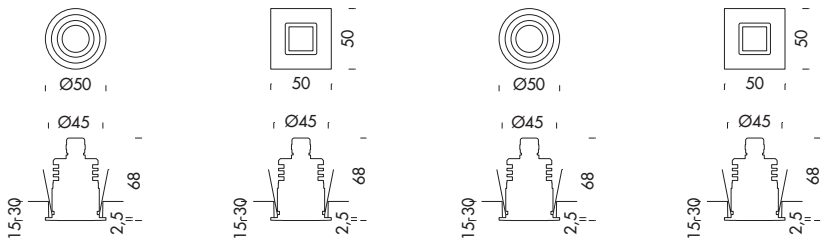

## CODE COMPOSITION

### ● FINISH

.3 - ANODIZED MATTE BLACK  
.5 - ANODIZED ALUMINUM  
.6 - AISI 316L S.STEEL

.3 - ANODIZED MATTE BLACK  
.5 - ANODIZED ALUMINUM  
.6 - AISI 316L S.STEEL

.3 - ANODIZED MATTE BLACK  
.5 - ANODIZED ALUMINUM  
.6 - AISI 316L S.STEEL

.3 - ANODIZED MATTE BLACK  
.5 - ANODIZED ALUMINUM  
.6 - AISI 316L S.STEEL

### ■ LED COLOR

.2 - 2700°K - CRI > 80  
.3 - 3000°K - CRI > 80  
.4 - 4000°K - CRI > 80

.2 - 2700°K - CRI > 80  
.3 - 3000°K - CRI > 80  
.4 - 4000°K - CRI > 80

.5 - RGB+W

.5 - RGB+W

### ▲ BEAM

.01 - 10° SPOT  
.02 - 30° MEDIUM  
.04 - 14° X 20° ELLIPTICAL  
.05 - DIFFUSED

.01 - 10° SPOT  
.02 - 30° MEDIUM  
.04 - 14° X 20° ELLIPTICAL  
.05 - DIFFUSED

.02 - 30° MEDIUM  
.05 - DIFFUSED

.02 - 30° MEDIUM  
.05 - DIFFUSED

## ACCESSORIES

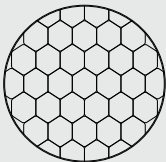

HONEYCOMB SCREEN  
(TO BE ORDERED TOGETHER  
WITH THE PRODUCT)

A1007



# FLEA UNDERWATER



## PERFORMANCE DATA

TRUE POWER (W)  
TRUE LUMENS (3000K)  
TRUE LUMENS (4000K)  
L90 LIFETIME (HRS)

4.0	8 (ALL COLORS)	4.0	8 (ALL COLORS)
411 (.01)	R=28, G=70,	411 (.01)	R=28, G=70,
428 (.01)	B=17, W=96 (6500K)	428 (.01)	B=17, W=96 (6500K)
90.000 - Ta 35°C	90.000 - Ta 35°C	90.000 - Ta 35°C	90.000 - Ta 35°C

## BUILD DATA

CLASS  
NOMINAL VOLTAGE  
POWER SUPPLY  
EXTERNAL CABLE  
  
PROTECTION RATING

III	III	III	III
24V DC - DIMMABLE	500mA	24V DC - DIMMABLE	500mA
SEE END OF SECTION	SEE END OF SECTION	SEE END OF SECTION	SEE END OF SECTION
SINGLE INPUT	SINGLE INPUT	SINGLE INPUT	SINGLE INPUT
2-POLES NEOPRENE 5MTS	8-POLES FEP+RUBBER 5MTS	2-POLES NEOPRENE 5MTS	8-POLES FEP+RUBBER 5MTS
IP68 - 3MTS	IP68 - 3MTS	IP68 - 3MTS	IP68 - 3MTS

## DIMENSIONS

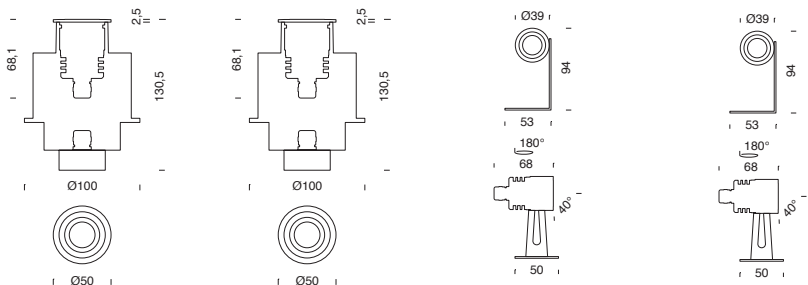

## CODE COMPOSITION

● FINISH

■ LED COLOR

▲ BEAM

50114	50115	50134	50135
●	●	●	●
■	■	■	■
▲	▲	▲	▲
.6 - AISI 316L S.STEEL	.6 - AISI 316L S.STEEL	.6 - AISI 316L S.STEEL	.6 - AISI 316L S.STEEL
.3 - 3000°K - CRI > 80	.5 - RGB+W	.3 - 3000°K - CRI > 80	.5 - RGB+W
.4 - 4000°K - CRI > 80		.4 - 4000°K - CRI > 80	
.01 - 10° SPOT	.02 - 30° MEDIUM	.01 - 10° SPOT	.02 - 30° MEDIUM
.02 - 30° MEDIUM	.05 - DIFFUSED	.02 - 30° MEDIUM	.05 - DIFFUSED
.04 - 14° X 20° ELLIPTICAL		.04 - 14° X 20° ELLIPTICAL	
.05 - DIFFUSED		.05 - DIFFUSED	

# DARK THEME

---

## MODE: ON

I NOSTRI MATERIALI SONO ECCEZIONALMENTE RIFINITI E PUR PRODUCENDO UNA LUCE INCREDIBILMENTE EFFICACE POSSIEDONO DELLE GHIERE CHE RIESCONO A FARSI NOTARE PER IL LORO STILE E ALTA PRECISIONE MECCANICA. TUTTAVIA, ALCUNE ARCHITETTURE RICHIEDONO UN CARATTERE DIVERSO; PER QUESTO MOTIVO, ABBIAMO AFFIANCATO ALLE NOSTRE FINITURE TRADIZIONALI UN'ELEGANTE VARIANTE IN NERO MATTE CHE INCASTONA LE FANTASTICHE SORGENTI DI FLEA A CUI SIETE GIÀ ABITUATI.

OUR MATERIALS ARE BOTH REFINED AND FUNCTIONAL. THEY PROVIDE EXCELLENT LIGHTING, ARE MECHANICALLY PRECISE, AND NOTICEABLY STYLISH. SOME SPACES REQUIRE A DIFFERENT DECOR; FOR THIS REASON, WE HAVE COMBINED OUR TRADITIONAL FINISHES WITH AN ELEGANT MATTE BLACK VARIANT IN TO FRAME THE FANTASTIC FLEA PRODUCTS THAT YOU'RE ALREADY USED TO.

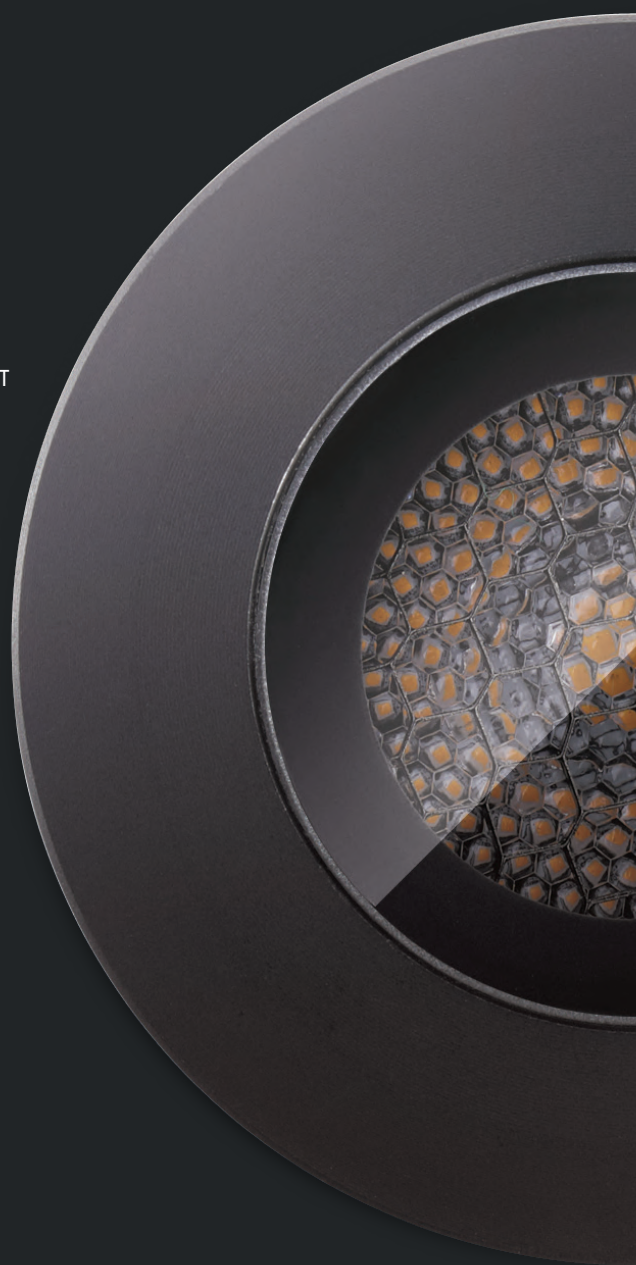
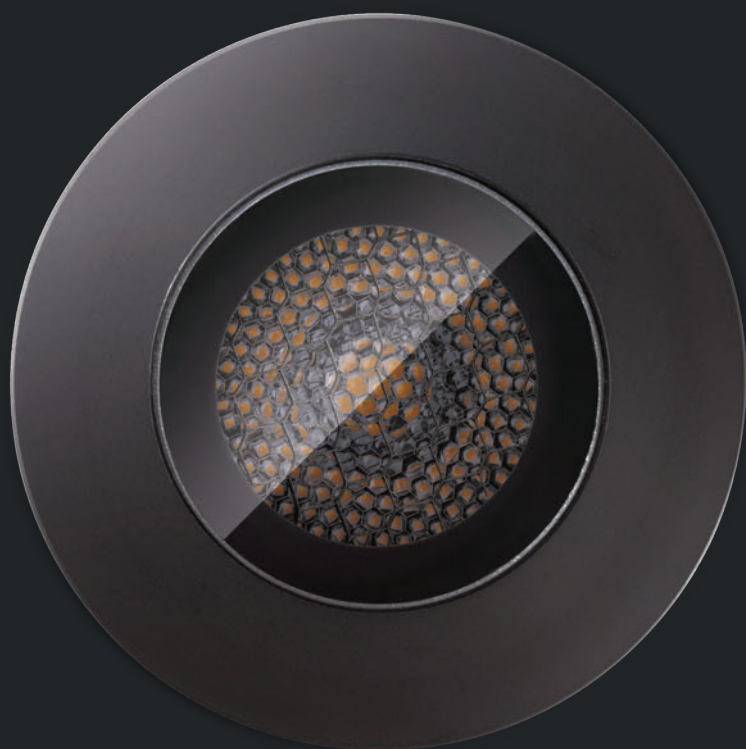

A VOLTE SI SENTE LA NECESSITÀ DI FILTRARE LEGGERMENTE LA LUCE PER EVITARE INVOLONTARI ABBAGLIAMENTI. SE QUESTO È IL VOSTRO CASO, FLEA VI ACCONTENTA CON UNA SERIE DI ACCESSORI RETICOLARI CHE VENGONO FORNITI OPZIONALMENTE SU TUTTA LA GAMMA: A VOI LA SCELTA!

IN ORDER TO AVOID DAZZLING, SOMETIMES YOU WOULD FEEL THE NEED OF FILTERING THE LIGHT. IF THIS IS YOUR CASE, FLEA MAKES YOU HAPPY WITH A RANGE OF MESH ACCESSORIES SOLD SEPARATELY FOR THE WHOLE COLLECTION. YOU CHOOSE!

# FLEA MAXI RECESSED

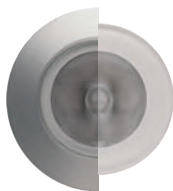

## PERFORMANCE DATA

TRUE POWER (W)	8.5
TRUE LUMENS (3000K)	464 (.01)
TRUE LUMENS (4000K)	484 (.01)
L90 LIFETIME (HRS)	90.000 - Ta 35°C

## BUILD DATA

CLASS	III
NOMINAL VOLTAGE	24V DC - DIMMABLE
POWER SUPPLY	SEE END OF SECTION
EXTERNAL CABLE	SINGLE INPUT
	2-POLES NEOPRENE
PROTECTION RATING	IP67 - IK10
MAX LOAD	1500KG (WALK OVER)

## DIMENSIONS

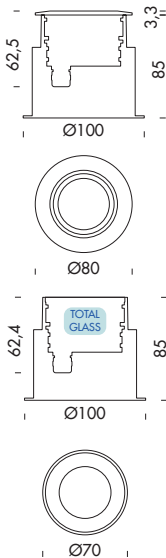

8.5
464 (.01)
484 (.01)
90.000 - Ta 35°C

III
24V DC - DIMMABLE
SEE END OF SECTION
SINGLE INPUT
2-POLES NEOPRENE
IP67 - IK10
1500KG (WALK OVER)

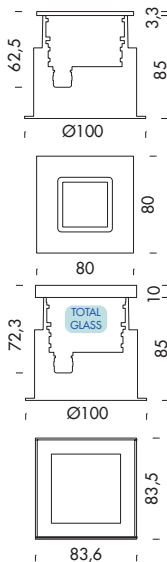

## CODE COMPOSITION



● FINISH	.3 - ANODIZED MATTE BLACK .5 - ANODIZED ALUMINUM .6 - AISI 316L S.STEEL .9 - TOTAL GLASS
■ LED COLOR	.2 - 2700°K - CRI > 80 .3 - 3000°K - CRI > 80 .4 - 4000°K - CRI > 80
▲ BEAM	.01 - 10° SPOT .05 - DIFFUSED .36 - 25° MEDIUM .32 - 45° WIDE .38 - 10° x 40°



.3 - ANODIZED MATTE BLACK .5 - ANODIZED ALUMINUM .6 - AISI 316L S.STEEL .9 - TOTAL GLASS
.2 - 2700°K - CRI > 80 .3 - 3000°K - CRI > 80 .4 - 4000°K - CRI > 80
.01 - 10° SPOT .05 - DIFFUSED .36 - 25° MEDIUM .32 - 45° WIDE .38 - 10° x 40°

## ACCESSORIES

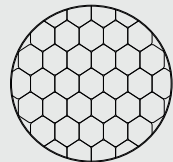

HONEYCOMB SCREEN  
(TO BE ORDERED TOGETHER  
WITH THE PRODUCT)

A1008

# FLEA MAXI RECESSED



CORE

**PERFORMANCE DATA**

TRUE POWER (W)  
TRUE LUMENS (3000K)  
TRUE LUMENS (4000K)  
L90 LIFETIME (HRS)

12 (ALL COLORS)  
R=33, G=84,  
B=20, W=116 (6500K)  
90.000 - T<sub>a</sub> 35°C

**BUILD DATA**

CLASS  
NOMINAL VOLTAGE  
POWER SUPPLY  
EXTERNAL CABLE

III  
24V DC - 4xPWM-CV  
SEE END OF SECTION  
SINGLE INPUT  
6-POLES FEP + RUBBER  
IP67 - IK10  
1500KG (WALK OVER)

PROTECTION RATING  
MAX LOAD

**DIMENSIONS**

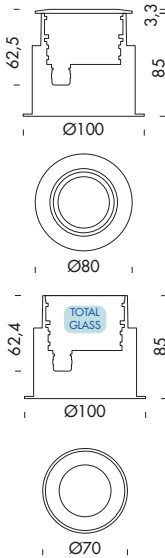

CORE

12 (ALL COLORS)  
R=33, G=84,  
B=20, W=116 (6500K)  
90.000 - T<sub>a</sub> 35°C

III  
24V DC - 4xPWM-CV  
SEE END OF SECTION  
SINGLE INPUT  
6-POLES FEP + RUBBER  
IP67 - IK10  
1500KG (WALK OVER)

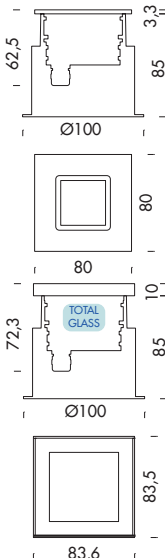

**CODE COMPOSITION**

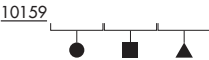

● FINISH

.3 - ANODIZED MATTE BLACK  
.5 - ANODIZED ALUMINUM  
.6 - AISI 316L S.STEEL  
.9 - TOTAL GLASS

■ LED COLOR

.5 - RGB+W

▲ BEAM

.01 - 10° SPOT  
.05 - DIFFUSED  
.36 - 25° MEDIUM  
.32 - 45° WIDE  
.38 - 10° x 40°

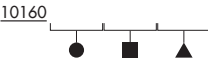

.3 - ANODIZED MATTE BLACK  
.5 - ANODIZED ALUMINUM  
.6 - AISI 316L S.STEEL  
.9 - TOTAL GLASS

.5 - RGB+W

.01 - 10° SPOT  
.05 - DIFFUSED  
.36 - 25° MEDIUM  
.32 - 45° WIDE  
.38 - 10° x 40°

**ACCESSORIES**

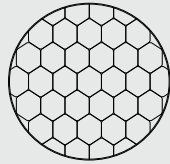

HONEYCOMB SCREEN  
(TO BE ORDERED TOGETHER  
WITH THE PRODUCT)

A1008

# FLEA MAXI C



1 x 180°

**PERFORMANCE DATA**

TRUE POWER (W)	6.5
TRUE LUMENS (3000K)	151 (.05)
TRUE LUMENS (4000K)	157 (.05)
L90 LIFETIME (HRS)	90.000 - Ta 35°C

**BUILD DATA**

CLASS	III
NOMINAL VOLTAGE	24V DC - DIMMABLE
POWER SUPPLY	SEE END OF SECTION
EXTERNAL CABLE	SINGLE INPUT
	2-POLES NEOPRENE
BEAM	1 x 180°
PROTECTION RATING	IP67 - IK10
MAXIMUM LOAD	1500KG (WALK OVER)

**DIMENSIONS**

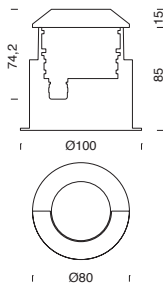

2 x 120°

TRUE POWER (W)	6.5
TRUE LUMENS (3000K)	179 (.05)
TRUE LUMENS (4000K)	186 (.05)
L90 LIFETIME (HRS)	90.000 - Ta 35°C

CLASS	III
NOMINAL VOLTAGE	24V DC - DIMMABLE
POWER SUPPLY	SEE END OF SECTION
EXTERNAL CABLE	SINGLE INPUT
	2-POLES NEOPRENE
BEAM	2 x 120°
PROTECTION RATING	IP67 - IK10
MAXIMUM LOAD	1500KG (WALK OVER)

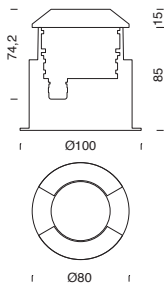

**CODE COMPOSITION**



● FINISH	.3 - ANODIZED MATTE BLACK .5 - ANODIZED ALUMINUM .6 - AISI 316L S.STEEL
■ LED COLOR	.2 - 2700°K - CRI > 80 .3 - 3000°K - CRI > 80 .4 - 4000°K - CRI > 80
▲ BEAM	.05 - DIFFUSED



● FINISH	.3 - ANODIZED MATTE BLACK .5 - ANODIZED ALUMINUM .6 - AISI 316L S.STEEL
■ LED COLOR	.2 - 2700°K - CRI > 80 .3 - 3000°K - CRI > 80 .4 - 4000°K - CRI > 80
▲ BEAM	.05 - DIFFUSED

# FLEA MAXI DOWNLIGHT



CORE

CORE

## PERFORMANCE DATA

TRUE POWER (W)  
TRUE LUMENS (3000K)  
TRUE LUMENS (4000K)  
L90 LIFETIME (HRS)

8.5  
464 (.01)  
484 (.01)  
90.000 (Ta 35°C)

8.5  
464 (.01)  
484 (.01)  
90.000 (Ta 35°C)

12 (ALL COLORS)  
R=33, G=84,  
B=20, W=116 (6500K)  
90.000 - Ta 35°C

12 (ALL COLORS)  
R=33, G=84,  
B=20, W=116 (6500K)  
90.000 - Ta 35°C

## BUILD DATA

CLASS  
NOMINAL VOLTAGE  
POWER SUPPLY  
EXTERNAL CABLE

III  
24V DC - DIMMABLE  
SEE END OF SECTION  
SINGLE INPUT  
2-POLES NEOPRENE  
IP67 - IK10

III  
24V DC - DIMMABLE  
SEE END OF SECTION  
SINGLE INPUT  
2-POLES NEOPRENE  
IP67 - IK10

III  
24V DC - 4xPWM-CV  
SEE END OF SECTION  
SINGLE INPUT  
6-POLES FEP + RUBBER  
IP67 - IK10

III  
24V DC - 4xPWM-CV  
SEE END OF SECTION  
SINGLE INPUT  
6-POLES FEP + RUBBER  
IP67 - IK10

## DIMENSIONS

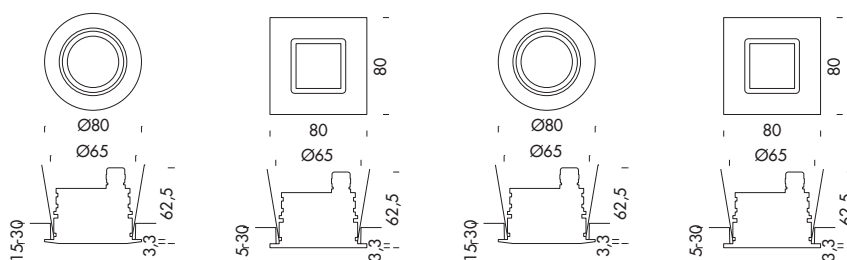

## CODE COMPOSITION

	20157	20158	20159	20160
● FINISH	.3 - ANODIZED MATTE BLACK .5 - ANODIZED ALUMINUM .6 - AISI 316L S.STEEL	.3 - ANODIZED MATTE BLACK .5 - ANODIZED ALUMINUM .6 - AISI 316L S.STEEL	.3 - ANODIZED MATTE BLACK .5 - ANODIZED ALUMINUM .6 - AISI 316L S.STEEL	.3 - ANODIZED MATTE BLACK .5 - ANODIZED ALUMINUM .6 - AISI 316L S.STEEL
■ LED COLOR	.2 - 2700°K - CRI > 80 .3 - 3000°K - CRI > 80 .4 - 4000°K - CRI > 80	.2 - 2700°K - CRI > 80 .3 - 3000°K - CRI > 80 .4 - 4000°K - CRI > 80	.5 - RGB+W	.5 - RGB+W
▲ BEAM	.01 - 10° SPOT .05 - DIFFUSED .36 - 25° MEDIUM .32 - 45° WIDE .38 - 10° x 40°	.01 - 10° SPOT .05 - DIFFUSED .36 - 25° MEDIUM .32 - 45° WIDE .38 - 10° x 40°	.01 - 10° SPOT .05 - DIFFUSED .36 - 25° MEDIUM .32 - 45° WIDE .38 - 10° x 40°	.01 - 10° SPOT .05 - DIFFUSED .36 - 25° MEDIUM .32 - 45° WIDE .38 - 10° x 40°

## ACCESSORIES

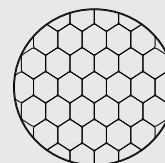

HONEYCOMB SCREEN  
(TO BE ORDERED TOGETHER  
WITH THE PRODUCT)

A1008

# FLEA MAXI UNDERWATER



**PERFORMANCE DATA**

TRUE POWER (W)	8.5
TRUE LUMENS (3000K)	464 (.01)
TRUE LUMENS (4000K)	484 (.01)
L90 LIFETIME (HRS)	90.000 - Ta 35°C

**BUILD DATA**

CLASS	III
NOMINAL VOLTAGE	24V DC - DIMMABLE
POWER SUPPLY	SEE END OF SECTION
EXTERNAL CABLE	SINGLE INPUT
	2-POLES NEOPRENE 5MTS
PROTECTION RATING	IP68 - 3MTS

**DIMENSIONS**

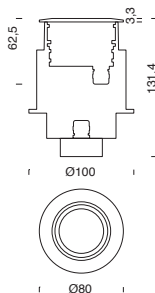

8.5
464 (.01)
484 (.01)
90.000 - Ta 35°C

III
24V DC - DIMMABLE
SEE END OF SECTION
SINGLE INPUT
2-POLES NEOPRENE 5MTS
IP68 - 3MTS

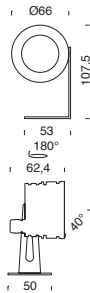

**CODE COMPOSITION**

● FINISH

■ LED COLOR

▲ BEAM



.6 - AISI 316L S.STEEL
.3 - 3000°K - CRI > 80
.4 - 4000°K - CRI > 80

.01 - 10° SPOT
.05 - DIFFUSED
.36 - 25° MEDIUM
.32 - 45° WIDE
.38 - 10° x 40°



.6 - AISI 316L S.STEEL
.3 - 3000°K - CRI > 80
.4 - 4000°K - CRI > 80

.01 - 10° SPOT
.05 - DIFFUSED
.36 - 25° MEDIUM
.32 - 45° WIDE
.38 - 10° x 40°